

PWCA-220S

Waveguide to Coaxial Adapter

WR42 to SMA Female,FBP220 Square

Electrical

Frequency Range	17.6-26.7 GHz	Waveguide Size	WR42/R220
Impedance	50 ohm	Flange Type	UBR220/FBP220,Square
VSWR	1.2 Max	Coax Connector	SMA Female
Average Power	-	Body Geometry	Right Angle

Configuration

Materials

Waveguide Body	Copper, black or grey painted	Operating Temp	-40°C to 70°C
Connector Body	Passivated stainless steel	Connector Interface	MIL-STD-348
Center Contact	Gold plated beryllium copper	RoHS	Compliant

Mechanical & Environmental

Dimensions(mm) Tolerance±1%

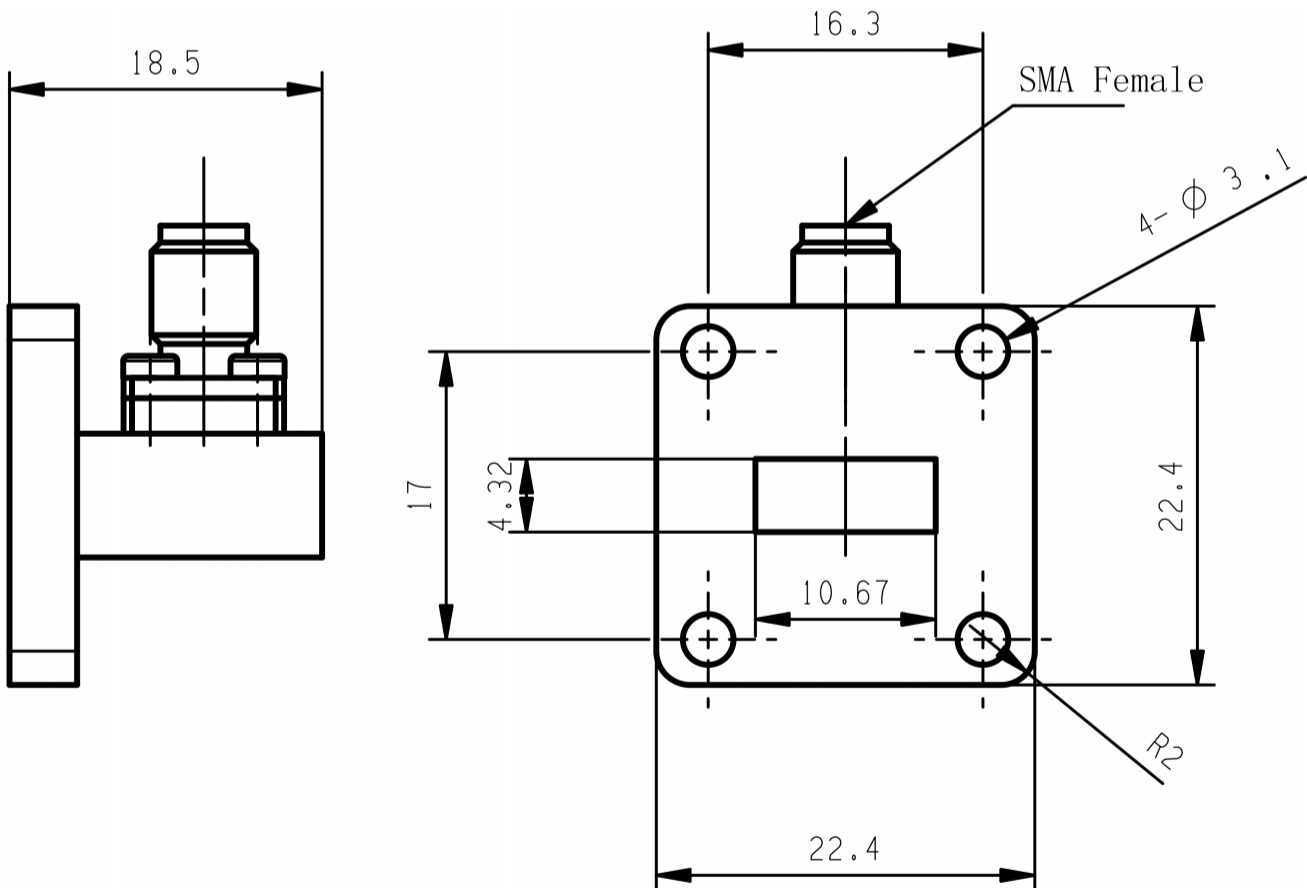

Typical Test Data

